

Road Closure Shadforth Lane Darwin

In accordance with the Local Government (Administration) Regulations Subordinate Legislation No 25 of 2008, Darwin City Council advises that it proposes to close and sell that portion of Shadforth Lane as shown in the concept plan. Following the road closure process, Registrations of Interest in purchasing and developing the land will be sought.

Objections to this proposal must be submitted in writing by no later than Monday 20 October 2008 to:

Chief Executive Officer
Darwin City Council
GPO Box 84
DARWIN NT 0801



See attached Survey Plan S2007-031

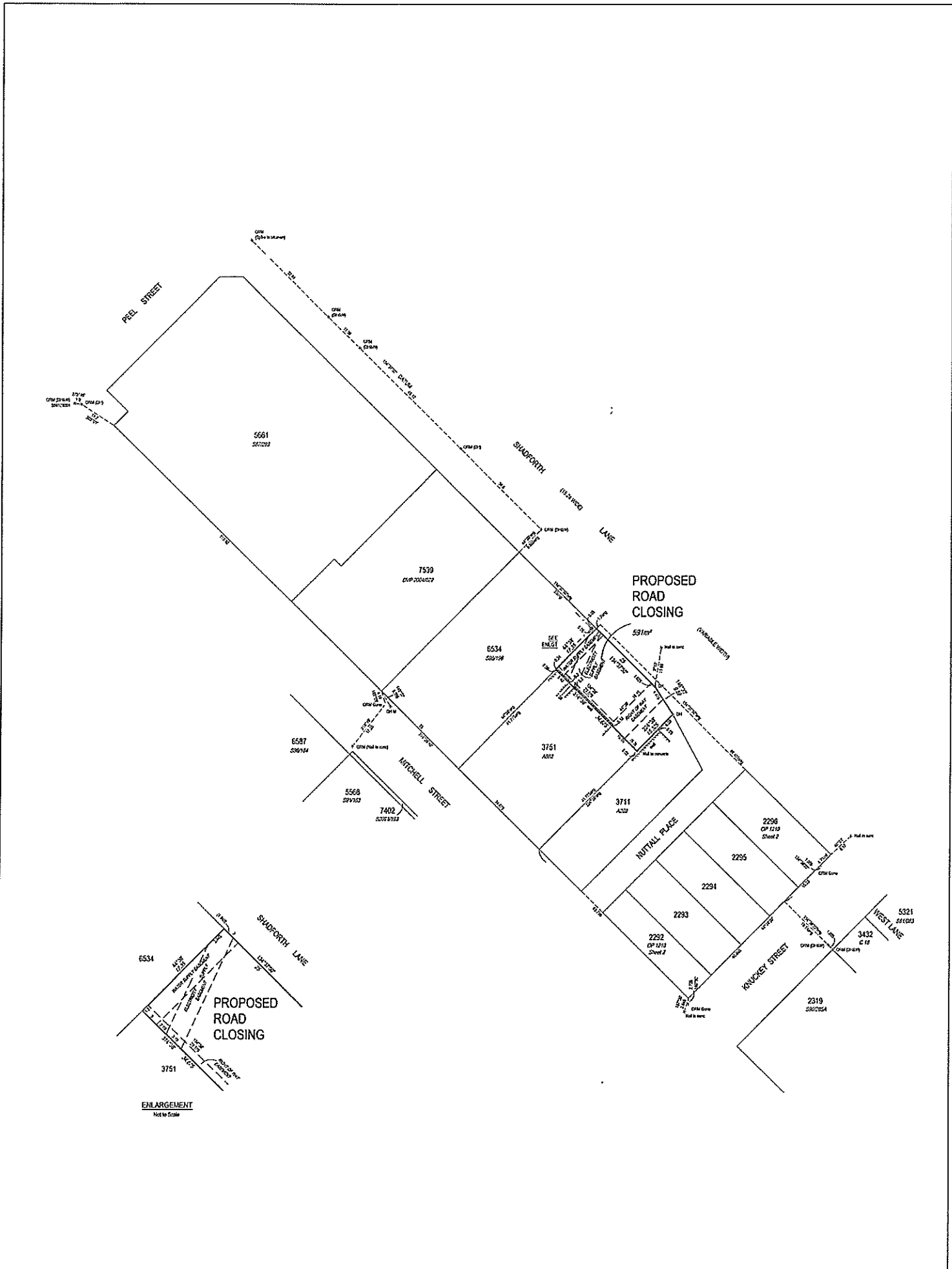

I, Keith Leslie Schür Licensed Surveyor 24-1-2008	I, Keith Leslie Schür Licensed Surveyor 24-1-2008	Note: Electricity Supply Equipment and Water Supply Equipment are in favour of the Power and Water Corporation. Right of Way Easement in favour of Lot 3751 and is limited to 7m x 4 to 8 metres above ground level.	7-odd Block S2007/231 Drawn East James & Associates (09) 523 33 04 08 Licensed East James & Associates 2/15/08 Map Reference	EJA Civil (Darwin Town District)	PROPOSED ROAD CLOSING TOWN OF DARWIN SCALE 1:500 	S2007/231
SURVEY APPROVED Delegate of the Surveyor General		Note: Electricity Supply Equipment and Water Supply Equipment are in favour of the Power and Water Corporation. Right of Way Easement in favour of Lot 3751 and is limited to 7m x 4 to 8 metres above ground level.		Legend: Concrete Post Concrete Block Peg or Wooden Post Reference Mark Lockup Fence Post	PROPOSED ROAD CLOSING TOWN OF DARWIN SCALE 1:500 	

NOTE: All damaged or unused plans will be recycled.