



Legend

-  Bollard
-  Temporary Fencing
-  Work Area

Lakeside Drive

"Worker Ahead (symbolic)" shall only be displayed whilst personnel are present and working at the site.
 "Traffic Controller (symbolic) / Prepare To Stop" shall only be displayed whilst traffic controllers are present and working at the site.

Site traffic controllers shall:

- 1) Not be located within 20m of mobile plant.
- 2) Ensure the safe passage of pedestrians around the site.
- 3) Open delineation to allow site construction vehicle access/egress as required.
- 4) Temporarily restrict approaching traffic enabling safe access for trucks to the traffic stream.
- 5) Observe and assist site construction workers as/is required to cross the active traffic lane on foot.

Stasinowski Street

40km/h speed restriction signage repeated every 100m past the site.

Bollard spacing 4m.





Date: 11/10/18 Author: Douglas Core, WZTM 1 Reg. # 10078, Exp. 31/10/19

Comments:

TGS, DTA002-101018 Lakeside Drive - Stasinowski Street, Stage 1
 Traffic guidance scheme detailing traffic management to be installed on behalf of DTA Contractors whilst conducting Stage 1 of the Lakeside Drive road pavement reconstruction.



Legend

-  Bollard
-  Temporary Fencing
-  Work Area

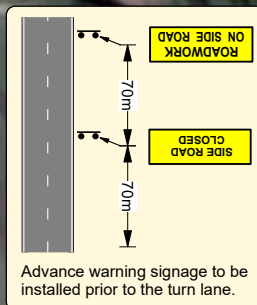

Freshwater Road

Trower Road inbound

Trower Road outbound

70m

Lakeside Drive

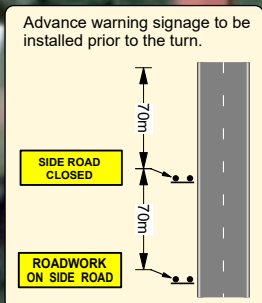

Date: 10/10/18 Author: Douglas Core, WZTM 1 Reg. # 10078, Exp. 31/10/19

Comments:

TGS, DTA002-101018 Trower Road - Lakeside Drive, Stage 1
Traffic guidance scheme detailing traffic management to be installed on behalf of DTA Contractors whilst conducting Stage 1 of the Lakeside Drive road pavement reconstruction.