

### Darwin Civic Centre

## Concrete Works Accelerate as Ground Floor Takes Shape, Installation of tower crane onsite



Work at the Civic Centre development site has advanced from installation of early-stage foundations to establishing the first defining elements of the Civic Centre's structure.

A key visible milestone this month is the establishment of the Lubeca Hydraulic Jump-form system. This self-climbing system allows the buildings core to rise with precision, dramatically improving safety and efficiency on site. Once the Jump-form system is fully established, the next phase will enable rapid vertical construction of the lift shafts, stairwells and major services risers.

Concrete pours continue to be a major focus, with fire tank walls successfully poured, substation walls formed, and additional ground slabs prepared ahead of further pours

The DCOH team continues to work closely with City of Darwin to coordinate the upcoming connection of on-site stormwater infrastructure to the external system.

A critical piece of work to keep us through the wet season.

### Milestones on site so far include:

- Installation of tower crane onsite
- Excavation and pouring of pad footings
- Commencement of shuttering and forming of the core
- Ongoing installation of in-ground power, water and services including stormwater
- Lubeca Jump-form system setup progressing
- Fire tank walls poured and substation wall forming completed
- Over 24,000 hours worked on site to date

### Fit-Out Design in the green

Design development continues to advance with coordination between architects, engineers and subcontractors particularly active on Levels 1 and 2 which are the most technically complex areas of the building.

Additional design updates for construction are also progressing, these include:

- Development and coordination to design the building's façade
- Structural design approved for construction
- Building Permit issued, covering the entire building structure
- Continued engagement with service authorities

The submission of 100% detailed design drawings ensures design documentation remains ahead of construction needs as vertical works commence.

### Waste Reduction Continues

Sustainability remains a central focus for the project. To date, more than 2,200 tonnes of materials have been recycled or reused, including concrete, timber and steel. Construction waste is being carefully separated onsite to maximise recycling outcomes and reduce landfill contributions.

Stormwater and sediment controls have been implemented in preparation for the wet season, ensuring protection of surrounding public spaces and waterways.

### Upskilling and safety at our core

Lubeca system training has continued onsite, upskilling local crews in the safe operation of the jump-form system ahead of core pouring works.

A representative for the Lubeca system will keep working on site to ensure the system gets set up correctly and local subcontract crews are appropriately trained in its operation.

Safety remains a priority with regular inspections, proactive hazard management and ongoing toolbox talks.

### Local context

- Over 24,000 hours worked, majority delivered by Northern Territory contractors and suppliers
- 6 apprentices/ trainees engaged to date
- Over 2,200 tonnes recycled/ reused

### Upcoming milestones

Activities planned for the coming month include:

- Full establishment and cycling of the Lubeca jump-form system
- Additional ground floor slab pours
- Formwork and preparation for Level 2 slabs
- Continued in-ground services installation
- Coordination with City of Darwin to finalise external stormwater connection

### Project background

As Darwin continues to grow and evolve, so too does the need for welcoming, inclusive public spaces that bring people together. The Civic Centre redevelopment will transform the existing complex into a vibrant community hub where people can work, play, celebrate, learn, meet, honour and remember - all while maintaining its home in Civic Park, a location that connects the CBD, Parliament House and Darwin Waterfront.

Delivered in partnership with DCOH, one of the Territory's leading construction and development companies, the new Civic Centre will create a modern, sustainable landmark for the city.

The design will protect and showcase the much-loved Tree of Knowledge (Galamarrma) as a central feature, while replacing the existing structure with an accessible, environmentally responsive building surrounded by green public spaces.

Once complete, the site will feature a new City Library, community meeting and function rooms, 410 parking spots for the community and a plaza linking to Civic Park and Cavenagh Street - cementing its place as the new heart of the Darwin CBD.

### Traffic Management

Traffic management measures remain in place to ensure the safety of pedestrians and road users around the site. Temporary fencing, controlled access points and clearly signed pedestrian diversions continue along Harry Chan Avenue and the Esplanade.

Traffic controllers are monitoring movement daily, and early morning concrete pours are coordinated to minimise disruption. Additional controls will be implemented as equipment movements increase with the "Jump core" system and upcoming slab cycles.

An updated traffic management plan can be found on the following page.

## November 2025

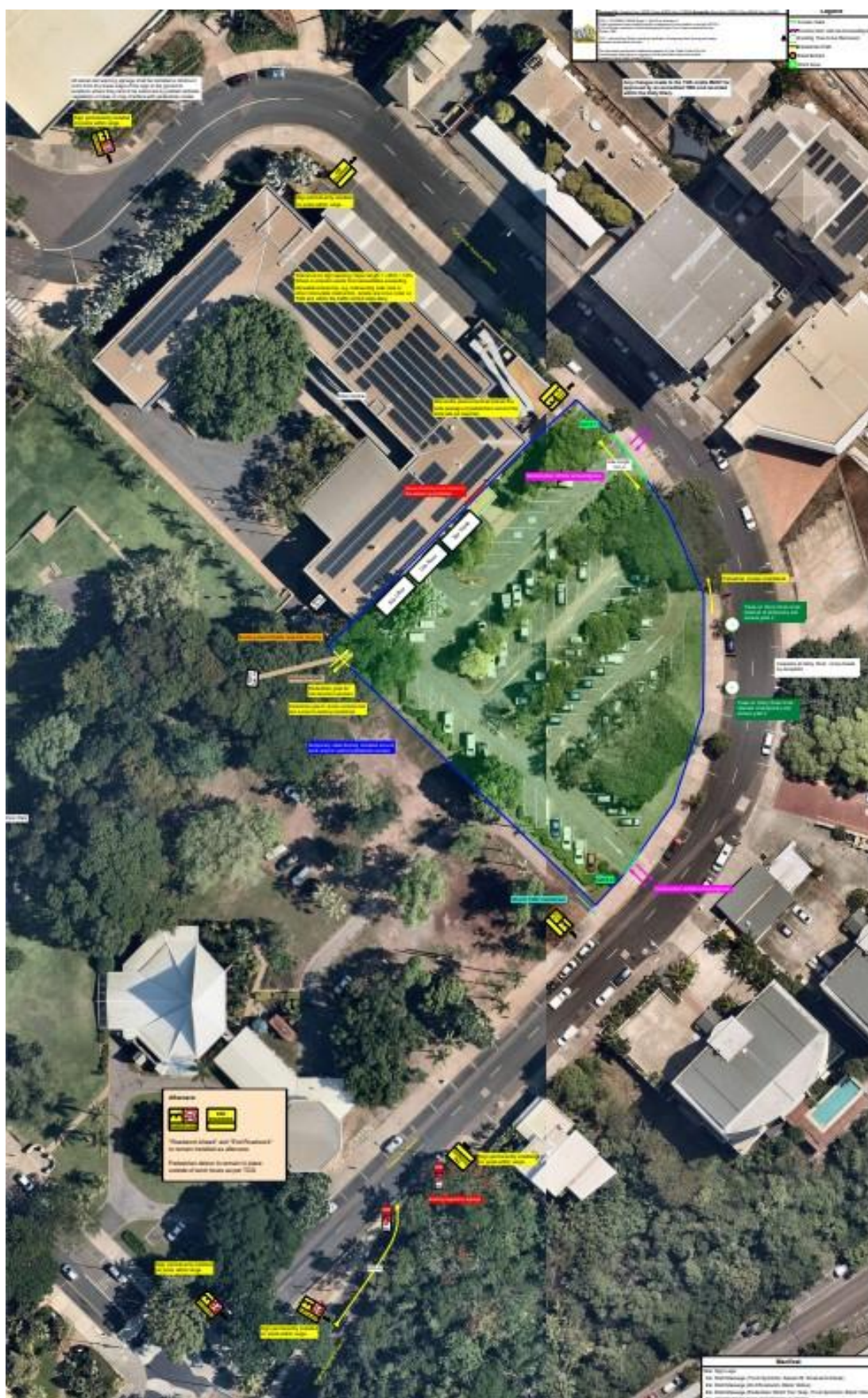

### Contact us

**Email:** [civiccentre.info@dcoh.au](mailto:civiccentre.info@dcoh.au)

**For more information, visit:** [darwin.nt.gov.au/projects/civic-centre-development](https://darwin.nt.gov.au/projects/civic-centre-development)